

# Installing position of MC6010/6015

Unit: mm

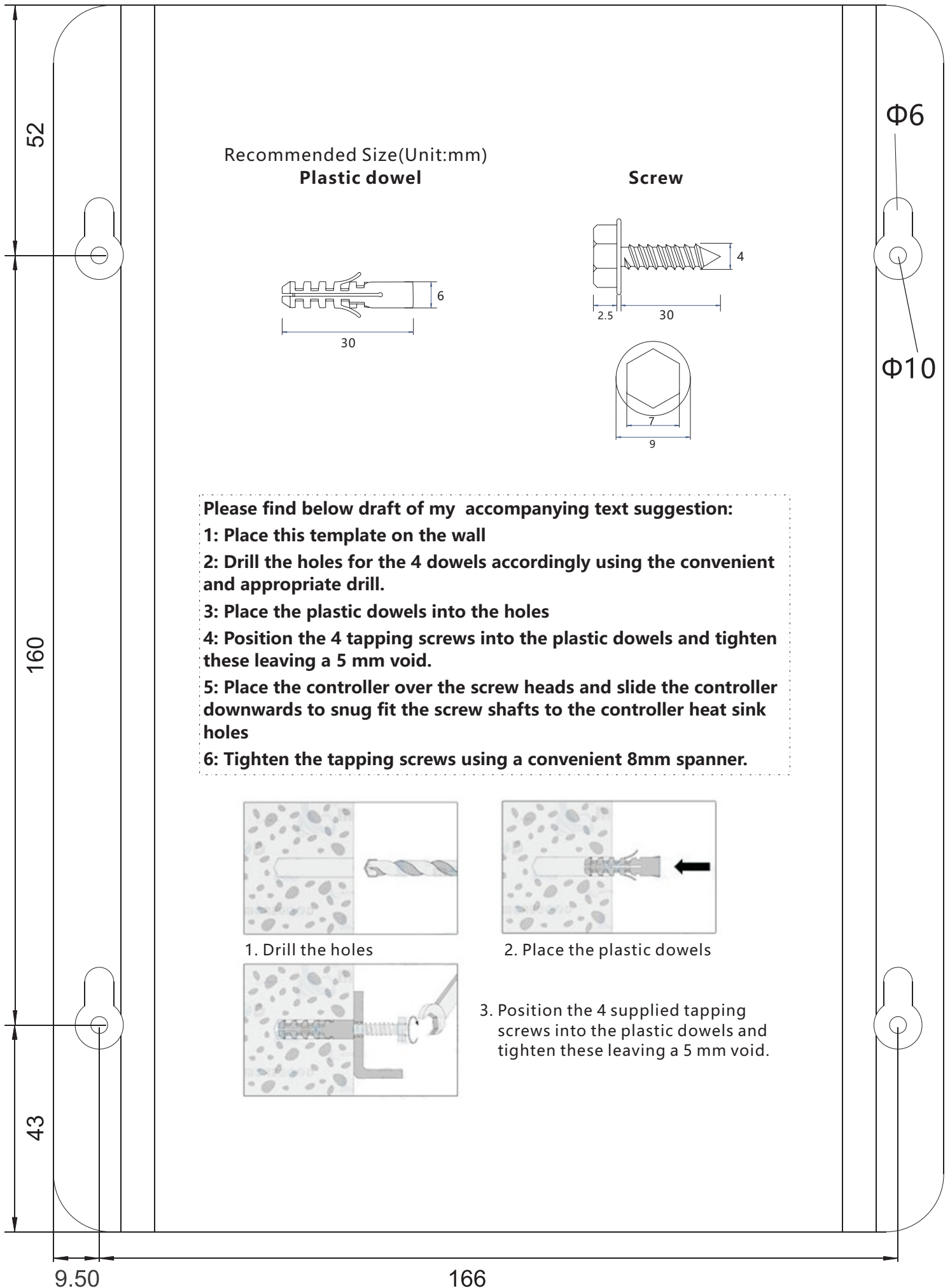

Recommended Size(Unit:mm)  
**Plastic dowel**

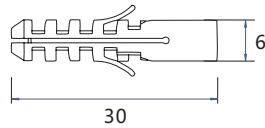

**Screw**

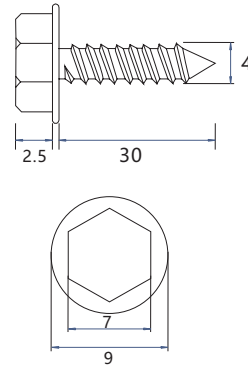

- Please find below draft of my accompanying text suggestion:
- 1: Place this template on the wall
  - 2: Drill the holes for the 4 dowels accordingly using the convenient and appropriate drill.
  - 3: Place the plastic dowels into the holes
  - 4: Position the 4 tapping screws into the plastic dowels and tighten these leaving a 5 mm void.
  - 5: Place the controller over the screw heads and slide the controller downwards to snug fit the screw shafts to the controller heat sink holes
  - 6: Tighten the tapping screws using a convenient 8mm spanner.



1. Drill the holes

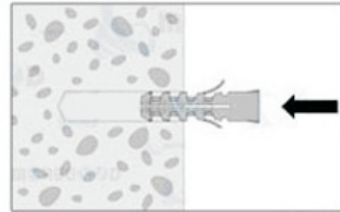

2. Place the plastic dowels

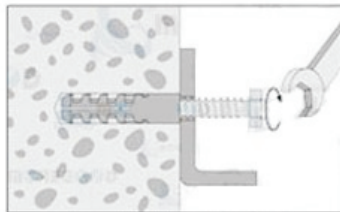

3. Position the 4 supplied tapping screws into the plastic dowels and tighten these leaving a 5 mm void.